

Model THE SAN MARCO TWO STORY

Description: 4 BEDROOMS; LIBRARY;
5 1/2 BATHS; EXPANSIVE SECOND FLOOR
LOUNGE AND MORNING ROOM; SECOND
FLOOR TERRACE; 3 CAR GARAGE; 5,600
SQ. FT. UNDER AIR; 7,150 SQ. FT. TOTAL.
PRICED AT \$3,100,000 FURNISHED.

Standard Features

- IMPACT GLASS WINDOWS AND DOORS
- CUSTOM WOOD FRONT ENTRY WITH IMPACT GLASS
- PRE-CAST COLUMNS AT FRONT AND REAR PORCHES
- PRE-CAST RAILING AT FRONT SECOND FLOOR BALCONY
- SECOND FLOOR TERRACE
- BUTLER'S PANTRY
- SECOND FLOOR MORNING BAR
- EXTERIOR BARBECUE ISLAND WITH REFRIGERATOR
- GAS FIREPLACE AND SURROUND
- MARBLE AND GRANITE COUNTERTOPS
- MARBLE FLOORING
- WOOD CABINETS
- CROWN MOLDING
- APPLIED MOLDINGS
- DECORATIVE BEAMS AT FAMILY ROOM
- BUILT-IN UNITS AT LIBRARY AND FAMILY ROOM

PRICES AND SPECIFICATIONS SUBJECT TO
CHANGE WITHOUT NOTICE



Ground Floor

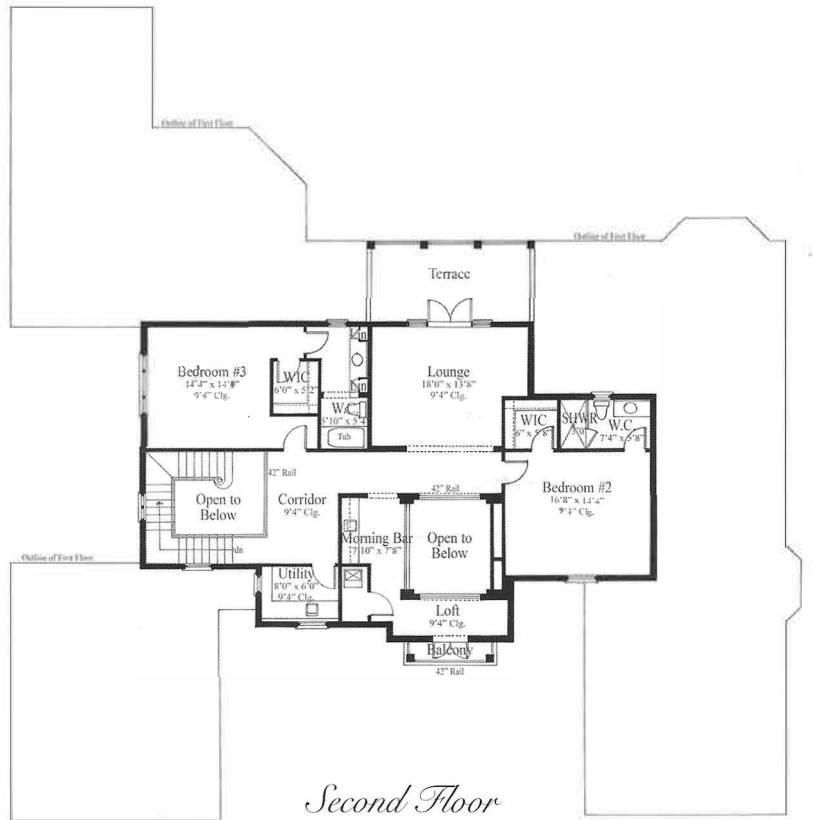

Second Floor

TESORO-PORT ST. LUCIE, FL 34984

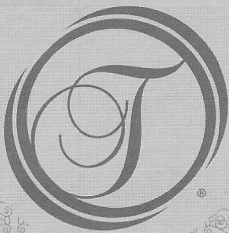

Developer does not guarantee the obligations of builders who may build and sell homes in the Development. Prices, plans, artist's rendering photos, land uses, dimensions, specifications, improvements, materials, amenities and availability are subject to change without notice. Ownership of a residence at the Development does not grant the use of or access to any golf course or other recreational facilities ("The Club") to be located at the Development. Use of amenities is subject to Membership requirements. Ginn Real Estate Company, LLC, Licensed Real Estate Broker.

First Floor

Second Floor

First Floor A/C =	4,070 sq. ft.
Second Floor A/C =	1,530 sq. ft.
Total A/C =	5,600 sq. ft.
Garage =	870 sq. ft.
Balcony =	210 sq. ft.
Covered Areas =	465 sq. ft.
<hr/>	
Total =	7,145 sq. ft.

